

Dodd Road Industrial Park Parcel 3 Walla Walla, Washington

Dodd Road Industrial Park is located in the western portion of Walla Walla County. Parcel 3 in the Dodd Road Industrial Park is 188 acres zoned Heavy Industrial. The site is adjacent to U.S. Highway 12, Union Pacific Railroad mainline, and 10 miles from Interstate 395. Parcel 3 is surrounded by a rail loop track (connected via Union Pacific Railroad mainline) owned by the Port of Walla Walla. The Dodd Road Industrial Park has excellent truck and rail access, potable and fire suppression water, electrical, and natural gas services and is ideal for heavy manufacturing or large warehouse distribution. The property can be subdivided to meet the business sitting requirements.

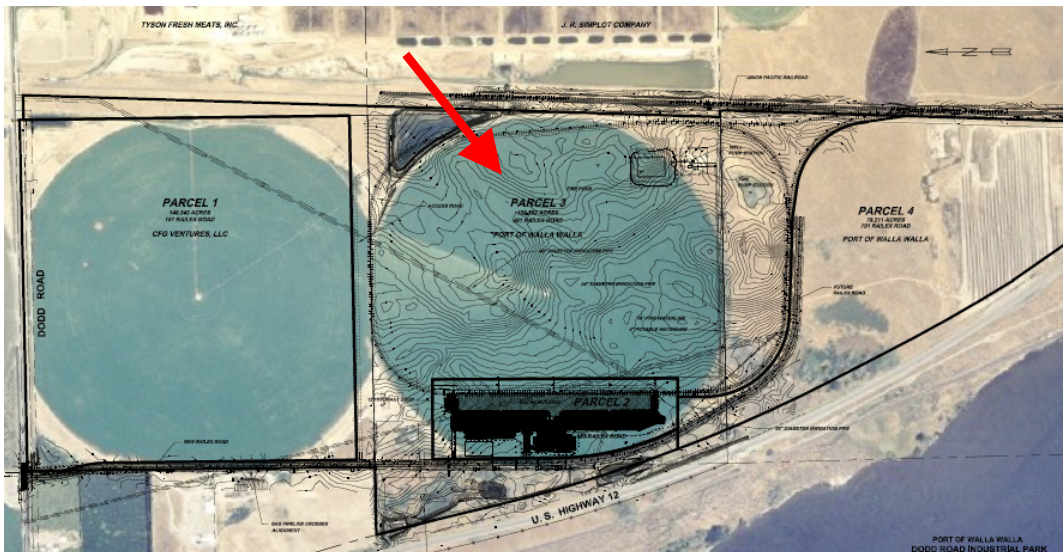

<u>Acreeage:</u>	188 Acres												
<u>Zoning:</u>	Heavy Industrial – No height restrictions												
<u>Utilities:</u>	<table border="0"> <tr> <td>Electrical:</td> <td>Pacific Power – On-Site</td> </tr> <tr> <td>Potable Water:</td> <td>Port of Walla Walla – On-Site</td> </tr> <tr> <td>Fire Water:</td> <td>Port of Walla Walla – On-Site</td> </tr> <tr> <td>Sewer:</td> <td>Engineered Septic</td> </tr> <tr> <td>Gas:</td> <td>Cascade Natural Gas – On-Site</td> </tr> <tr> <td>Telephone:</td> <td>Qwest Communications – On-Site</td> </tr> </table>	Electrical:	Pacific Power – On-Site	Potable Water:	Port of Walla Walla – On-Site	Fire Water:	Port of Walla Walla – On-Site	Sewer:	Engineered Septic	Gas:	Cascade Natural Gas – On-Site	Telephone:	Qwest Communications – On-Site
Electrical:	Pacific Power – On-Site												
Potable Water:	Port of Walla Walla – On-Site												
Fire Water:	Port of Walla Walla – On-Site												
Sewer:	Engineered Septic												
Gas:	Cascade Natural Gas – On-Site												
Telephone:	Qwest Communications – On-Site												
<u>Transportation:</u>	<table border="0"> <tr> <td>Highway:</td> <td>U.S Highway 12 – Adjacent</td> </tr> <tr> <td>Rail:</td> <td>Rail Loop - On-site - UPRR</td> </tr> <tr> <td>Airport:</td> <td>Tri-City Regional Airport - 15 miles</td> </tr> </table>	Highway:	U.S Highway 12 – Adjacent	Rail:	Rail Loop - On-site - UPRR	Airport:	Tri-City Regional Airport - 15 miles						
Highway:	U.S Highway 12 – Adjacent												
Rail:	Rail Loop - On-site - UPRR												
Airport:	Tri-City Regional Airport - 15 miles												

**For more information contact Jim Kuntz or Paul Gerola
at the Port of Walla Walla at 509-525-3100.**